

London Borough of Camden, Town Hall, Judd Street, London WC1H 9JE

Premises Licence Summary
London Borough of Camden Licensing Authority

Premises licence number

PREM-LIC\087057

Part 1 – Premises details

Postal address of premises, or if none, ordnance survey map reference or description:

Zero 75
201A BELSIZE ROAD
LONDON
NW6 4AA

Telephone number N/A

Where the licence is time limited the dates

N/A

Licensable activities authorised by the licence

Retail of Alcohol: Yes

The times the licence authorises the carrying out of licensable activities

Retail of Alcohol:
Monday to Sunday: 12:00-22:00

The opening hours of the premises:

Monday to Saturday: 10:00-23:00
Sunday: 10:00-22.30

Where the licence authorises supplies of alcohol whether these are on and/or off supplies:

ON the premises only

Part 2**Name, (registered) address of holder of premises licence**

Ramiz Gashi
201A Belsize Road
London
NW6 4AA

Registered number of holder, for example company number, charity number (where applicable)

N/A

Name of designated premises supervisor where the premises licence authorises the supply of alcohol

Ramiz Gashi

State whether access to the premises by children is restricted or prohibited

N/A

Annex 1 - Mandatory conditions

1. The supply of alcohol is prohibited at a time when there is no designated premises supervisor in respect of the premises.
2. The supply of alcohol is prohibited at a time when the designated premises supervisor does not hold a personal licence or his/her licence is suspended.
3. Every supply of alcohol under the premises licence must be made or authorised by a person who holds a personal licence.
4. Where a premises licence includes a condition that at specified times one or more individuals must be at the premises to carry out a security activity, the licence must include a condition that each such individual must
 - (a) be authorised to carry out that activity by a licence granted under the Private Security Industry Act 2001; or
 - (b) be entitled to carry out that activity by virtue of section 4 of that Act.
5. But nothing in subsection (4) requires such a condition to be imposed -
 - (a) in respect of premises within paragraph 8(3)(a) of Schedule 2 to the Private Security Industry Act 2001 (c. 12) (premises with premises licences authorising plays or films), or
 - (b) in respect of premises in relation to -
 - (i) any occasion mentioned in paragraph 8(3)(b) or (c) of that Schedule (premises being used exclusively by club with club premises certificate, under a temporary event notice authorising plays or films or under a gaming licence), or
 - (ii) any occasion within paragraph 8(3)(d) of that Schedule (occasions prescribed by regulations under that Act).
6. For the purposes of this section
 - (a) "security activity" means an activity to which paragraph 2(1)(a) of that Schedule applies[and which is licensable conduct for the purposes of that Act (see section 3(2) of that Act)], and
 - (b) paragraph 8(5) of that Schedule (interpretation of references to an occasion) applies as it applies in relation to paragraph 8 of that Schedule.
7.
 - (1) The responsible person must ensure that staff on relevant premises do not carry out, arrange or participate in any irresponsible promotions in relation to the premises.
 - (2) In this paragraph, an irresponsible promotion means any one or more of the following activities, or substantially similar activities, carried on for the

purpose of encouraging the sale or supply of alcohol for consumption on the premises

- (a) games or other activities which require or encourage, or are designed to require or encourage, individuals to
 - (i) drink a quantity of alcohol within a time limit (other than to drink alcohol sold or supplied on the premises before the cessation of the period in which the responsible person is authorised to sell or supply alcohol), or
 - (ii) drink as much alcohol as possible (whether within a time limit or otherwise);
 - (b) provision of unlimited or unspecified quantities of alcohol free or for a fixed or discounted fee to the public or to a group defined by a particular characteristic in a manner which carries a significant risk of undermining a licensing objective;
 - (c) provision of free or discounted alcohol or any other thing as a prize to encourage or reward the purchase and consumption of alcohol over a period of 24 hours or less in a manner which carries a significant risk of undermining a licensing objective;
 - (d) selling or supplying alcohol in association with promotional posters or flyers on, or in the vicinity of, the premises which can reasonably be considered to condone, encourage or glamorise anti-social behaviour or to refer to the effects of drunkenness in any favourable manner;
 - (e) dispensing alcohol directly by one person into the mouth of another (other than where that other person is unable to drink without assistance by reason of disability).
8. The responsible person must ensure that free potable water is provided on request to customers where it is reasonably available.
9. (1) The premises licence holder or club premises certificate holder must ensure that an age verification policy is adopted in respect of the premises in relation to the sale or supply of alcohol.
- (2) The designated premises supervisor in relation to the premises licence must ensure that the supply of alcohol at the premises is carried on in accordance with the age verification policy.
- (3) The policy must require individuals who appear to the responsible person to be under 18 years of age (or such older age as may be specified in the policy) to produce on request, before being served alcohol, identification bearing their photograph, date of birth and either
- (a) a holographic mark, or
 - (b) an ultraviolet feature.
10. The responsible person must ensure that
- (a) where any of the following alcoholic drinks is sold or supplied for consumption on the premises (other than alcoholic drinks sold or supplied having been made up in advance ready for sale or supply in a securely

closed container) it is available to customers in the following measures

(i) beer or cider: ½ pint;

(ii) gin, rum, vodka or whisky: 25 ml or 35 ml; and

(iii) still wine in a glass: 125 ml;

(b) these measures are displayed in a menu, price list or other printed material which is available to customers on the premises; and

(c) where a customer does not in relation to a sale of alcohol specify the quantity of alcohol to be sold, the customer is made aware that these measures are available.

11. A relevant person shall ensure that no alcohol is sold or supplied for consumption on or off the premises for a price which is less than the permitted price.

12. For the purposes of the condition set out in paragraph 11

(a) "duty" is to be construed in accordance with the Alcoholic Liquor Duties Act 1979

(b) "permitted price" is the price found by applying the formula

$$P = D + (D \times V)$$

where

(i) P is the permitted price,

(ii) D is the rate of duty chargeable in relation to the alcohol as if the duty were charged on the date of the sale or supply of the alcohol, and

(iii) V is the rate of value added tax chargeable in relation to the alcohol as if the value added tax were charged on the date of the sale or supply of the alcohol;

(c) "relevant person" means, in relation to premises in respect of which there is in force a premises licence

(i) the holder of the premises licence,

(ii) the designated premises supervisor (if any) in respect of such a licence, or

(iii) the personal licence holder who makes or authorises a supply of alcohol under such a licence;

(d) "relevant person" means, in relation to premises in respect of which there is in force a club premises certificate, any member or officer of the club present on the premises in a capacity which enables the member or officer to prevent the supply in question; and

(e) "value added tax" means value added tax charged in accordance with the Value Added Tax Act 1994.

13. Where the permitted price given by Paragraph (b) of 12 above would (apart from this paragraph) not be a whole number of pennies, the price given by that sub-paragraph shall be taken to be the price actually given by that sub-paragraph rounded up to the nearest penny.

14. (1) Sub-paragraph (2) applies where the permitted price given by Paragraph

(b) of paragraph 2 on a day ("the first day") would be different from the permitted price on the next day ("the second day") as a result of a change to the rate of duty or value added tax.

(2) The permitted price which would apply on the first day applies to sales or supplies of alcohol which take place before the expiry of the period of 14 days beginning on the second day.

Annex 2 - Conditions consistent with the operating schedule

16. The premises licence holder shall ensure that CCTV cameras and recorders are installed at the premises and are of a standard acceptable to and approved by the Police.
17. The system shall be maintained in good working order and at all times the premises is open to the public, be fully operational covering both internal and external areas of the premises to which the public have access.
18. The CCTV camera views are not to be obstructed.
19. At least one CCTV camera is to be placed no more than seven feet above floor level; near to the exit in order to capture clear facial images of all persons leaving the premises.
20. The medium on which CCTV images are recorded shall be of evidential quality; stored securely; shall be retained for a period of 31 days; and be available for inspection by the Police or Local Authority upon request.
21. At all times when the premises are open for the purposes of licensable activities, a suitably trained member of staff shall be present to assist the Police or an authorised officer in obtaining the CCTV footage.
22. Copies shall be made available within 48 hours to the Police or Local Authority, upon request.
23. The facility to transfer the images to a compatible, removable format, shall be held on the premises.
24. Staff working at the premises shall be trained in the use of CCTV and a log will be kept to verify this.
25. Signs must be displayed in the customer areas to advise that CCTV is in operation.
26. If the CCTV is inoperative or not installed and working to the satisfaction of the Police, then within 48 hours the Police shall be notified and an estimate given of the repair timescale. The premises shall comply with all reasonable requests from the Police.
27. Police must be called to all incidents of violence.

28. An incident log shall be kept at the premises, and made available on request to an authorised officer or the Police, which will record the following:
 - (a) all crimes reported to the venue
 - (b) any incidents of disorder and violence
 - (c) any faults in the CCTV system
 - (d) any refusal of the sale of alcohol to include date, time, and staff member
 - (e) any visit by a relevant authority or emergency service
 - (f) CAD reference numbers where Police are called.
29. The licensee will ensure that staff are trained, as appropriate, in respect of relevant Licensing Law; crime scene best practice and upon the sale of alcohol to drunks and to persons underage. Training shall be written into a programme, on-going review and will be made available for inspection by Police or other responsible authority, upon request.
30. No persons carrying visibly open or sealed alcohol vessels shall be admitted to the premises at any time that the premises are open for any licensable activity.
31. No patron shall be allowed to leave the premises whilst in the possession of any open drinking vessel or open glass bottle whether empty or containing any beverage. This includes patrons using the smoking area(s)
32. A Challenge 21 policy will be enforced, where any person reasonably looking under the age of 21 shall be asked to prove their age when attempting to purchase alcohol and signs to this effect will be displayed at the premises. The only acceptable forms of identity will be those with photographic identification documents recognised in the Home Office guidance; including passports, photo-card driving licence or proof of age card bearing the PASS hologram
33. The venue shall not engage the services of street promoters to encourage clientele to attend the venue.
34. There shall be no vertical drinking. Alcohol will only be sold by waiter/waitress service to customers seated at tables.
35. A personal licence holder to be present at the venue at all times when the venue is open during licensed hours.
36. All flat surfaces in toilet cubicles, including any curved toilet roll holder ellipses, are to be 'designed-out' - to the satisfaction of the MPS - in order to prevent drugs misuse.
37. For off sales, no lagers or ciders, over 6% ABV to be sold or stored on the premises.
38. All alcohol is to be covered and locked behind secure metal shutters when the

premises remain open outside the permitted hours for the supply of alcohol.

39. No alcohol to be stored beneath the serving counters at any time.
40. All products to be paid for in full at the point of sale. No 'credit' to be offered to any customers.
41. The premises shall implement a dispersal policy and all staff shall be trained in its implementation.
42. Notices shall be prominently displayed at each exit from the premises asking patrons to be considerate to neighbours when leaving.
43. An incident log shall be maintained by the premises that details incidents of note that occur in the premises. This shall include refused sales, disorder and ejections as a minimum. The log book shall be kept on the premises and be available for inspection at all times the premises is open, Management shall regularly check the book to ensure all staff are using it.
44. There shall be no more than 30 people in the premises at any one time including patrons and staff.
45. No drinks shall be taken outside.
46. No more than 3 patrons shall be permitted to smoke outside the premises at any one time.
47. The premises licence holder shall ensure that deliveries, collections and operational servicing are carried out between 07:00 and 19:00 hours, except where access at all other times is unavoidable and specific procedures are in place to limit disturbance.
48. There shall be no vertical drinking

Annex 3 - Conditions attached after a hearing by the licensing authority

N/A

Annex 4 - Plans

Rev.	Date	Details	By
0	13.12.2017	FIRST ISSUE	RCA

Date: 13.12.2017

Scale: 1:40 @ A3

Architect:

Client:

Project:

Drawing Title:



over 100 pp

Do not scale drawings.
All dimensions to be verified on site.

GROUND FLOOR

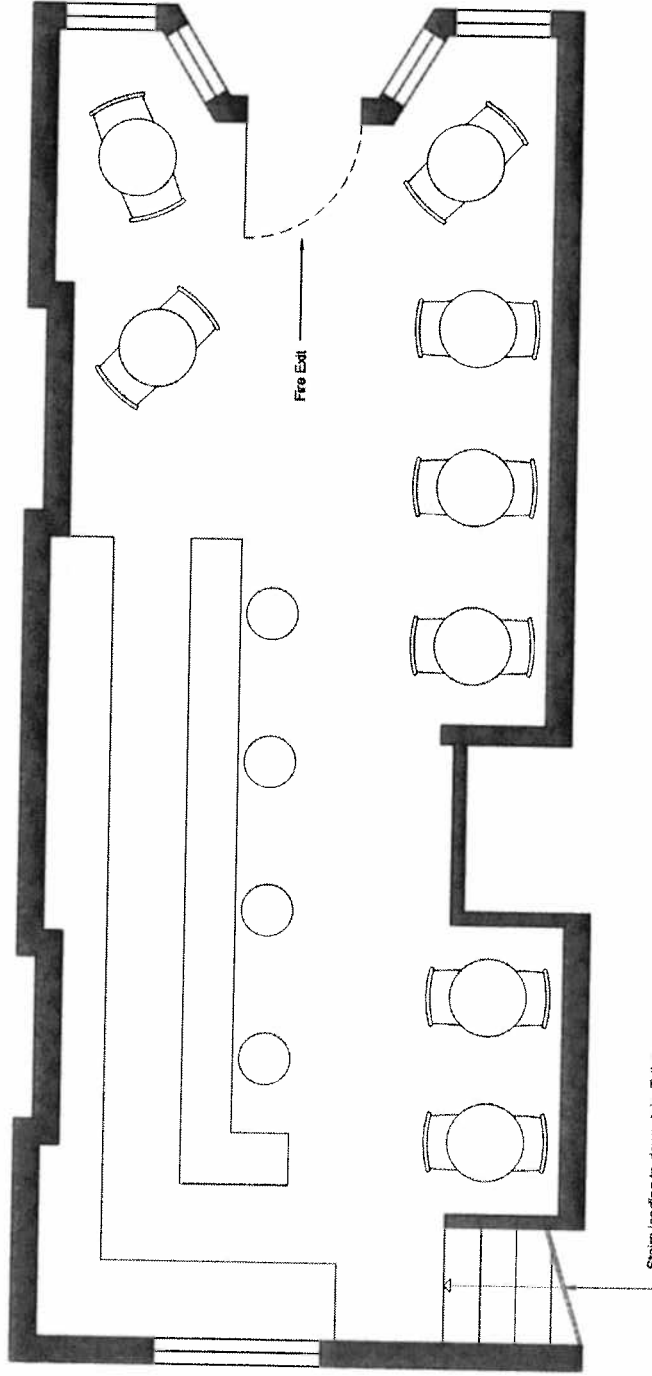

GROUND FLOOR

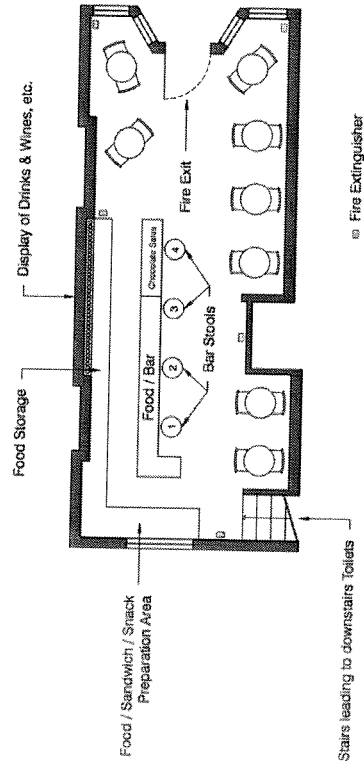

Copyright © 2017 ANAQUE ASSOCIATES

Rev: 0 Date: 13.12.2017 Drawn: FIRST ISSUE By: N.A.

Date: 13.12.2017

Scale: 1:100 @ A3

Architect:

Client:

Project:

Drawing Title:



Drawn By:

FP

NS

Do not scale drawings.
All dimensions to be verified on site.

Rev:	Date:	Scale:	By:
0	13.12.2017	FIRST ISSUE	N/A

Date: 13.12.2017

Scale: 1:100 @ A3

Architect:

Client:

Project:

Drawing Title:



Drawn By:

IFP

Do not scale drawings.
All dimensions to be verified on site.

BASEMENT

